

# **| USER MANUAL**

Tips: Please read this manual carefully before use and keep it properly.  
Do not ride until you know the performance of this product.

# Content

1. Safety instructions .....	01
2. Products and accessories .....	04
3. Function diagram .....	05
4. How to assembly .....	07
5. Check before riding .....	09
6. How to ride .....	09
7. How to charge .....	11
8. Product specifications .....	14
9. Daily maintenance .....	15
10. Warranty service .....	19
11. Legal statements .....	20

## 1.Safety instructions

1. Electric scooters are a recreational product. In order to ensure the safety of cyclists, please read this manual carefully before using this product, practice and master the riding skills through the correct guidance. If the rider is inexperienced or does not use in accordance with this manual, the company will not bear any responsibility for any damage.
2. Please follow local laws and traffic regulations. Do not ride electric scooters in areas where they are prohibited by law. Do not ride electric scooters on public transport roads. Do not ride on the road infested with motor scooters under any circumstances, otherwise serious injury or death may result.
3. There is a risk of injury or death from loss of the electric scooter control, collisions and falls when using electric scooter. To reduce risk, riders must read and follow all "cautions" and "warnings" in the instructions. Following the warnings and tips in this manual reduces risk, but does not eliminate all risk. Please ride with caution and knowledge of driving.
4. This product must be assembled and adjusted by the rider's guardian or other adult. This product should not be accessible to people under 16 years of age.
5. The package contains wrenches, plastic bags and other items. Please keep them away from minors.
6. Do not give the electric scooter to someone who cannot operate it. Please ensure that others are aware of the correct usage of this product before giving it to them for use. You are responsible for the safety of new riders. Please assist him/her in learning to use the product until he/she has learned the basic operation. Please ensure that each new rider wears a helmet and other protective gear and uses them if a guardian is required. Please deliver the product with this instruction when you hand it over to others.

### Riding environment and pavement

1. Avoid riding on steep slopes, bumpy roads, slippery roads, pits, sewage openings, stairs, snow, water edges, near furnaces, flower beds, expansion joints, construction roads, debris and other obstacles. When riding, you should observe and avoid traffic at any time, and try to Keep a slow cycling speed. Too fast cycling is prone to accidents such as scooter losing control and falling injury.
2. For whatever reason, do not ride in snowy, rainy, slippery, muddy, or icy conditions. Doing so could cause the scooter to lose its balance or grip, leading to a fall. Riding in rainy weather can cause water to enter the scooter, leading to the risk of functional damage, fire or even explosion due

to the wet battery. Damage and loss due to water intake are not covered by the warranty.

3. Please do not ride in bad weather or poor visibility (e.g. at night).

### **Riding precautions**

1. Only one person is allowed to ride the electric scooter. Overloading is strictly prohibited!
2. Please wear helmets and knee and elbow pads when riding. Please use a good quality bicycle helmet.
3. Grip the handlebars with both hands when riding. Do not hang ornaments, heavy objects, etc. on the handlebars.
4. Do not speed up or slow down suddenly while riding. Please do not go faster than the e-scooter limit.
5. When riding, avoid putting your hands and feet into the rolling wheel.
6. When riding, please pay attention to the road conditions and avoid obstacles and roads that are not easy to ride (including but not limited to slippery ground, loose sand, gravel ground and ice).

### **⚠ Warning**

If the electric scooter gives out abnormal sound or alarm sound, please stop using it immediately.

### **Rider requirements**

People who are not suitable to ride this product include:

- I. Persons under the influence of alcohol or drugs.
- II. Persons who are unable to perform strenuous physical activity due to medical conditions, especially those with heart, neck and back problems.
- III. People who can't keep their balance.
- IV. Persons whose age, height and weight are not within the prescribed limits.
- V. Persons with limited intelligence who are unable to understand the proper use of electric scooter and the associated risks.

## Operation notice

1. Only parts and accessories designated or approved by the company can be used. Do not modify the electric scooter, otherwise it may affect the operation, leading to serious injury/damage and warranty void. Electric bicycle contains electrical components, do not remove.
2. Do not drive the electric scooter when the ambient temperature exceeds the operating temperature of the product (please refer to the "Product specifications"), because low/high temperature will lead to the limitation of the maximum power and the degradation of the product performance. Doing so may cause a slip or fall, or even result in personal injury or property damage.
3. Please do not let minors touch fenders, wheels and other structures with gaps. Do not touch the brake or hub motor after riding to avoid burns caused by elevated component temperature.
4. Please park the electric scooter on the flat and firm road as much as possible. It is recommended to park near the wall. Do not park in busy areas. If parked on the slope, the electric bicycle foot support must be oriented downhill to prevent overturning. Please do not let the electric bicycle head down, to prevent the kickstand closed and scooter fall over under the action of gravity. After putting down the kickstand, please check whether the body of the scooter is stable, to prevent the scooter from falling over(due to sliding, wind or shaking etc.).
5. Regular maintenance of product is recommended for a better driving experience (see "Daily care and maintenance").
6. Users must read the charging steps and precautions in this manual before charging (please refer to "How to Charge").

## 2.Products and accessories

### User information

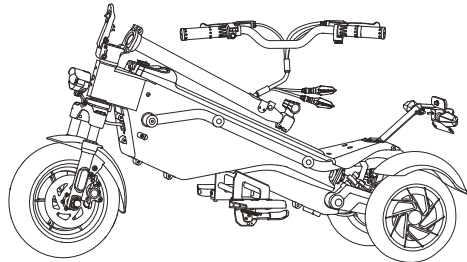
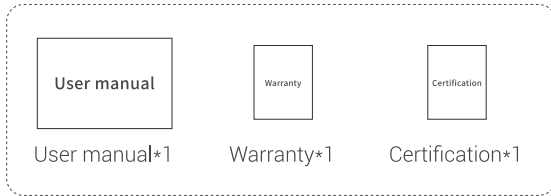

scooter body\*1

### Accessories

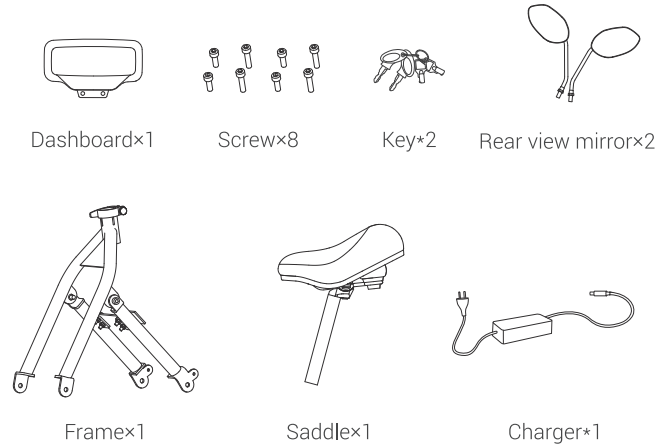

Please carefully check whether the items in the packaging box are complete and in fact of any missing or broken items.

### 3.Function diagram

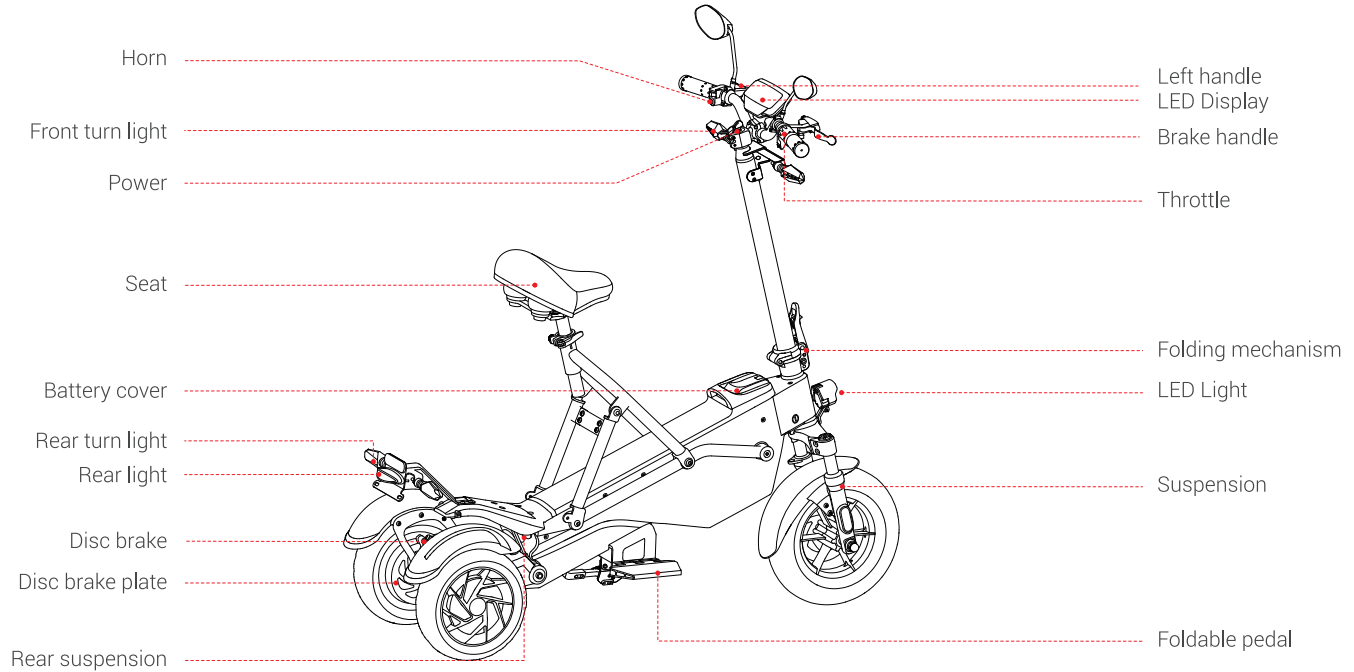

## Display

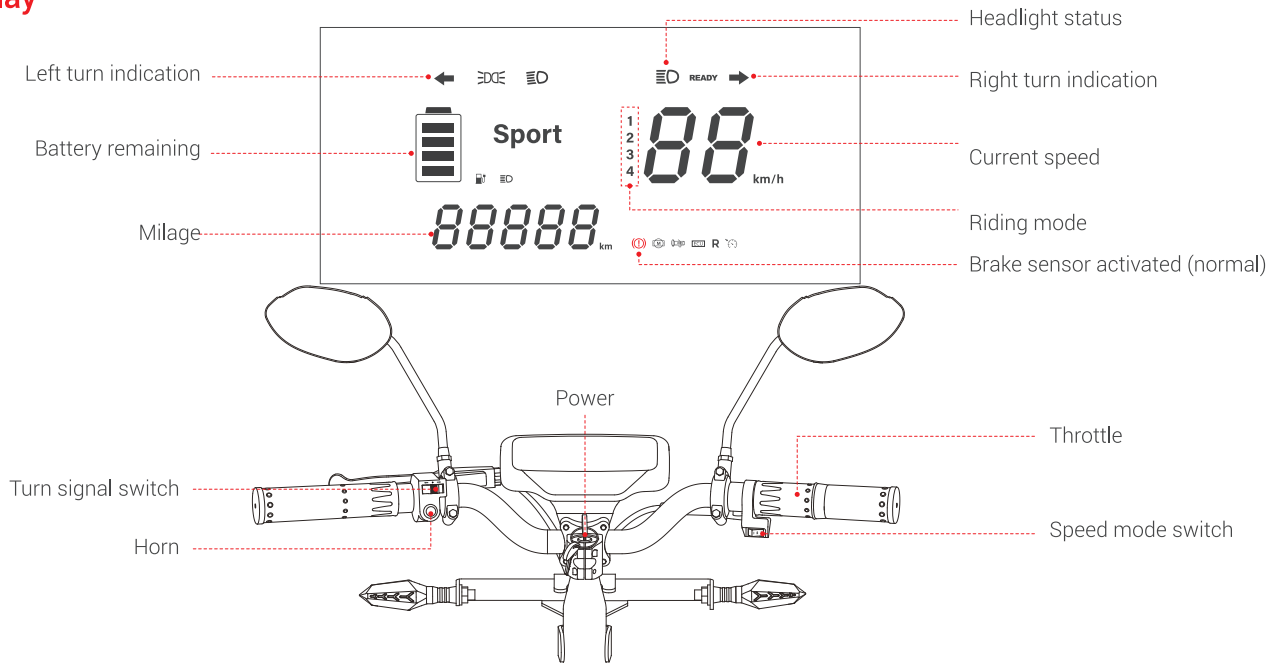

1. When the power is turned on for the first time, the accumulated distance will be displayed, which will be displayed as the current driving mileage and reset to zero when restarted.
2. If the warning sign is abnormal, please contact customer service center for consultation.



## 4.How to assembly

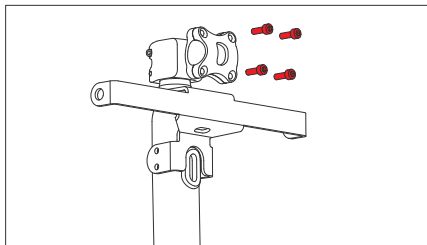

1. Unscrew the four screws.

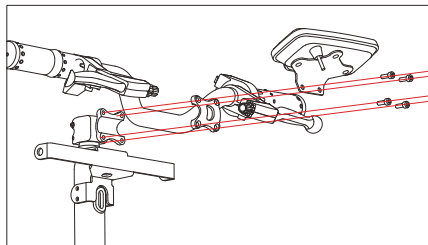

2. Place the elbow and instrument panel as shown in the figure, align the holes and tighten them with screws.

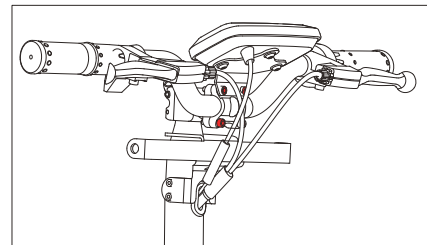

3. Dashboard wires and power cord connect them.

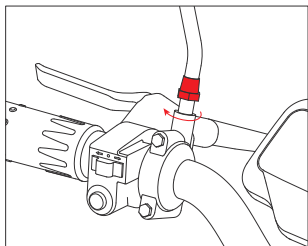

4. As shown in the figure, screw the rear view mirror clockwise to the proper position.

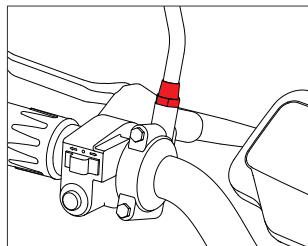

5. Tighten the nut at the bottom of the rear-view mirror clockwise.

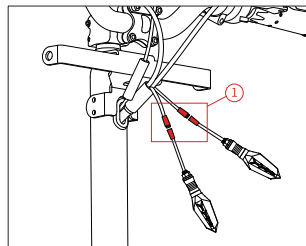

6. Separate the power connection wire at ① as shown in the figure, and unscrew the nut on the steering lamp.

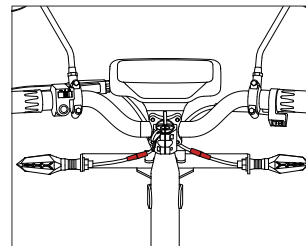

7. Insert the unscrewed lamp caps into the holes on the pole holder, screw on the nuts, tighten them counterclockwise, and finally connect the power cord.

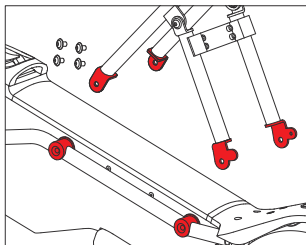

8. Find out the four screws, as shown in the picture, align the frame with the holes on both sides of the scooter.

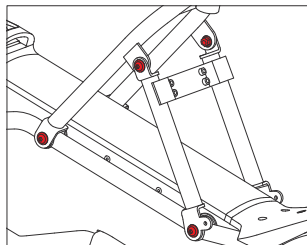

9. Tighten the screws.

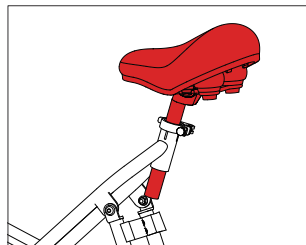

10. Insert the saddle as shown.

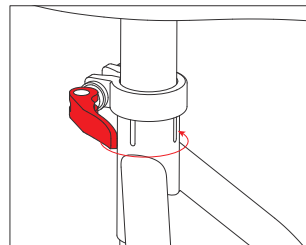

11. Please ensure that the seat does not flip back or shake when pressed, and the latch is fastened in the direction shown in the picture.

### Pole folding method

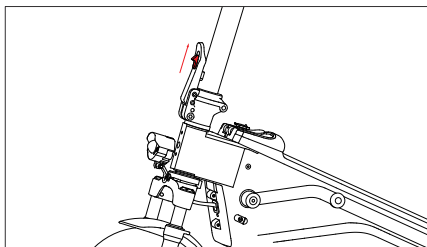

1. As shown in the figure, move upward the red latch.

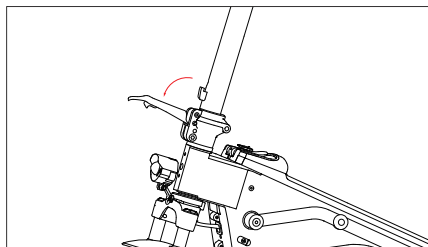

2. Meanwhile, push the folder towards the front wheel.

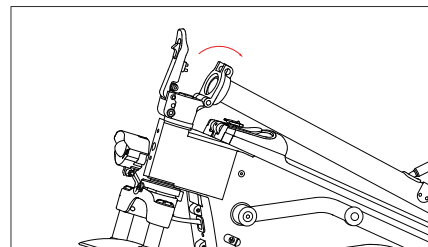

3. After the lock direction is placed as shown in the picture, press down to fix the pillar (confirm whether the cushion is fixed before riding).

**Note:** This product needs to be folded after the frame is disassembled. Please confirm whether the frame has been disassembled before folding.

## 5. Check before riding

To reduce the occurrence of accidental injuries, the following items should be checked before each ride:

1. Check scooter status, tire and brake effect, etc. Ensure that no parts including the handlebars, risers, tires, brake lines, brake handles, fenders, and screws show any signs of loosening or damage.
2. When the power is low, the scooter does not have enough power to maintain normal cycling. Please make sure that the power is sufficient to avoid danger.
3. Must wear a helmet and a full set of knee pads, wrist pads, elbow pads, wear sports shoes, and wear clothes suitable for sports. Long hair or enough to affect the line of sight bangs, broken hair should be tied up, so as not to block the line of sight affect normal riding.
4. For your first ride, please do not choose the areas where children, pedestrians, pets, vehicles or other obstacles and potential hazards may occur.

**Note:** If there are any abnormal signs, please stop using it immediately and contact the after-sales service for testing guidance.

## 6. How to ride

1. Preparation:

There is a risk of falling and injury, so wear a helmet and protective gear all the time.

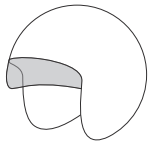

Helmet

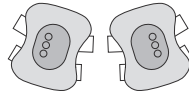

Protective

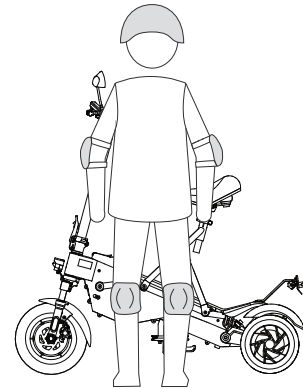

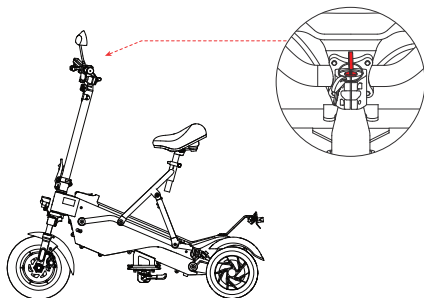

2. Power on: Turn the key clockwise to unlock and power on. And check the power indicator. If the power is too low, please charge it immediately.

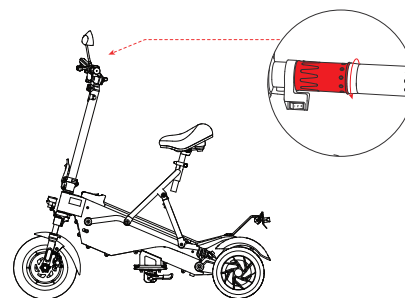

3. Start: before riding, straighten the body, adjust the sitting position, ensure it's on low speed level, turn the throttle slowly, and touch the ground with both feet; When the scooter is moving smoothly, retract your feet and place them on the pedals.

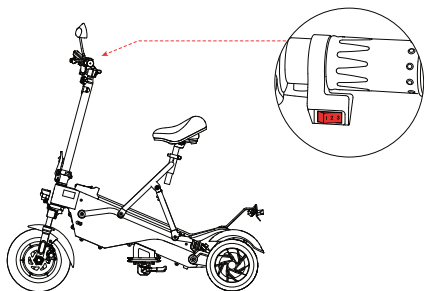

4. Speed switch: You can change speed from 1 to 3 by the speed switch .

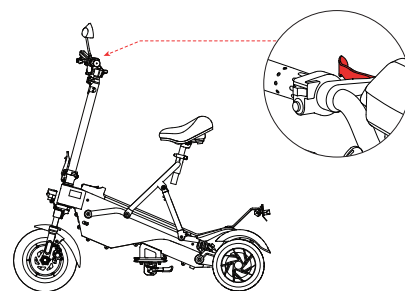

5. Decelerate/brake: release throttle to decelerate. Emergency braking requires rapid pressure on the brake handlebars.

**Warning:** Quick braking may fall due to insufficient.

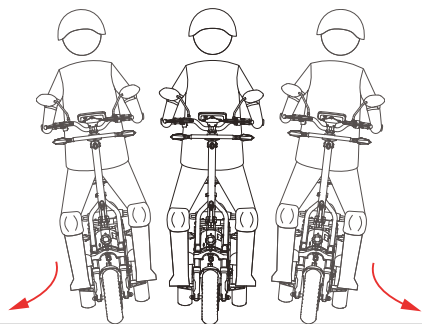

6. Turning: When turning, lean your center of gravity slightly and slowly turn your handle.

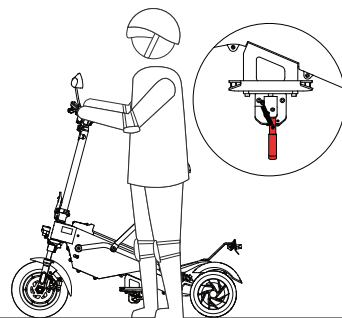

7. Get off: After cycling, please park the scooter on the flat road and long press on to turn off the power; drop the foot support to avoid slipping or falling.

## 7.How to charge

Due to battery self-consumption during transportation and storage, it is normal for the battery to be low or no battery when used for the first time. Please charge according to the following charging steps. You can choose two ways for charging: outside charging and whole scooter charging. Do not allow minors to use the charging equipment.

### ① Whole scooter charging

Find the charging port on the left side of the scooter body and open the rubber plug of the charging port. First connect the output end of the charger to the charging port of the scooter body and then connect the power supply. After charging, fasten the rubber plug.

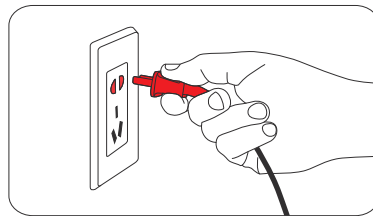
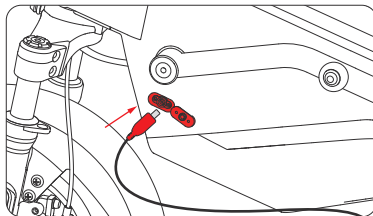
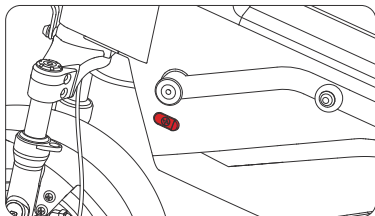

## ② External charging

Take out the battery, find the charging port, open the rubber plug of the charging port, first connect the output end of the charger to the charging port of the body, and then connect the power supply. After charging, buckle the rubber plug.

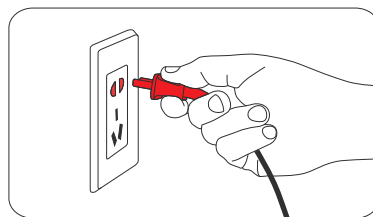
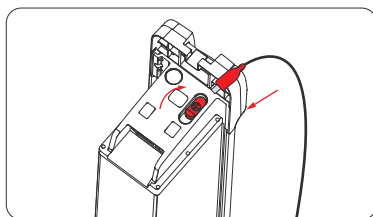
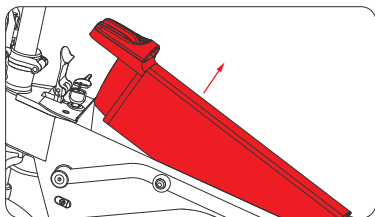

\*The red light of the charger means the charger is working. The green light means the charging is finished. Please cut off the power after the battery is fully charged. If the temperature of the vehicle body exceeds 40 C , the vehicle will not be charged normally. Please wait until it drops below 40 C before charging.

## **⚠ Warning**

1. Please charge with the power off.
2. Please use the original charger to charge, only use the charger designated or approved, otherwise the battery may be damaged or in danger of fire.
3. Do not charge when the charging port, power socket or charging line is wet. If the vehicle is flooded, the battery is damaged or flooded, it is prohibited to charge or continue to use the battery.
4. In the process of charging, if the indicator light is abnormal or there is abnormal smell, stop charging immediately and contact the after-sales service or replace the charger.
5. The charger shall be kept away from inflammables and explosives when working. The charger is not a toy. Please place it in a safe place where child cannot touch.
6. Disconnect the power immediately after charging. Do not connect the charger to the power supply for a long time when it is not charged.
7. It is necessary to regularly check whether the charger wire, plug, shell and other parts are damaged, and stop using it if it is found to be damaged, until it is repaired or the charger is replaced.

## **Battery disassembly method**

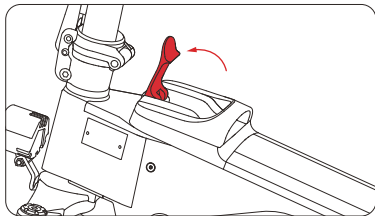

1.As shown,first open the lock on the battery case.

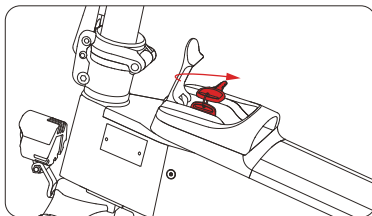

2.Use a special key to lock/open the battery cover on the body.

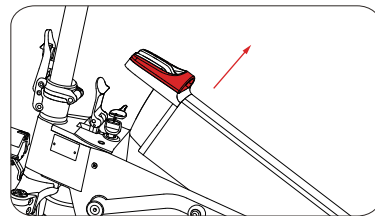

3.Hold the upper end of the battery box and lift the handle.

## 8.Product specifications

Model	Bestride pro-F2
Colour	orange(OEM)
Maximum battery capacity	23.4Ah
Maximum range	45km
Motor	48V500W*2
Tire	Front 12 inch rear 10 inch tubeless air tire
Standard working voltage	48V
Battery Type	Lithium battery
Brake	front and rear disc brake
Rated maximum load	150Kg
Lights	Headlights
weight	48.7kg
Expanded size	1280*605*1260mm
Storage temperature	0 C ~35 C
Charging temperature	10~35 C

You can choose the appropriate version according to your own needs, and in the future Bestride pro-F2 will launch various optional upgrade accessories and color style kits, please consult your dealer for details.



## 9. Daily maintenance

Users should obey the following tips to maintain electric bicycles:

### Clean

Wipe the main frame clean with a soft damp cloth. For hard-to-clean stains, use a professional cleaner to scrub repeatedly, then clean with a soft damp cloth.

**Note:** Do not use alcohol, gasoline, kerosene or other corrosive and volatile solvents to clean. These substances may damage the exterior and interior structure of the vehicle body.

### ⚠ Warning

- Do not use pressure water guns or hose sprays for flushing.
- During the cleaning process, keep the electric bicycle turned off, unplug the charging cable and fasten the rubber cover of the charging port, otherwise it may cause electric shock or serious failure due to internal water.

### Storage

When not in use, try to store it in a dry and cool place indoors, and try to avoid storing it outdoors for a long time. Sun exposure/hot/cold outdoor conditions will accelerate the aging of the appearance and tires and reduce the service life of the body and its battery pack. Before storing, please fully charge the electric bicycle, if it is not used for a long time, please charge it regularly to prevent the battery from discharging. Do not store it in a dusty environment to avoid damage to electrical components. Can not be stored together with chemicals, acids, alkalis and other substances.

### ⚠ Warning Do not go near the fire source!

### Move

Before moving, make sure that the electric bicycle is turned off. During the handling process, please handle with care, do not throw, heavy pressure, rain, moisture and violent collision are strictly prohibited.

## Battery Maintenance and Recycling

A well-maintained battery will keep running well even after many miles of driving. Generally speaking, a fully charged battery will use up its stored power in 120-180 days after it is turned off. If it is not used for a long time, it should be charged every 30-60 days. Charge the battery after each drive. A completely depleted battery may cause permanent damage. There is a smart chip inside the battery to record the charge and discharge of the battery. Damage due to over charging or undercharging is not covered under warranty.

- Do not remove or disassemble the battery.
- Do not use other types or brands of battery packs, otherwise there may be safety risks.
- It is forbidden to charge in areas prohibited by the laws of the country/region and relevant management units.
- Do not touch the battery contacts and do not open or puncture the case. Avoid metal objects touching the battery contacts to cause a short circuit, otherwise it may cause battery damage or personal injury.
- Do not throw the battery pack into a fire, otherwise it may cause the battery to fail, overheat, or even risk a fire.
- When storing or charging the battery, do not exceed the specified temperature limits (see "Product Specifications").
- Improper disposal of used batteries may seriously pollute the environment. Waste batteries cannot be disassembled without authorization, and should be recycled by relevant professional departments. Please abide by local regulations and do not discard the battery pack at will, so as to protect the natural environment.

## Charger

- Chargers should be used exclusively for vehicles, and it is strictly forbidden to charge non-rechargeable batteries;
- Confirm whether the connected power is 110V-220V AC power;
- If you find damaged lines or loose connectors, do not use them, please contact the after-sales service or designated authorized service;
- When charging, the vehicle should be in a safe place, be ware of rain and sun exposure;
- When charging, insert the vehicle's charging port first, then the charger's power plug;
- During the charging process, if the indicator light is abnormal, there is a strange smell or the charger case is overheated, the charging should be cut off immediately;

- After the battery is fully charged, cut off the power supply of charger first, then unplug the charger;
- After the charger has cooled down, tidy up the power cord and charging cable and place them in a safe place;

### **Other**

- When the brake cable is loose or the brake is not sensitive, the brake cable screw can be adjusted.
- The external cord of the charger cannot be replaced. If the cord is damaged, please replace the charger in time.
- Tire repairs should be performed by professional service personnel.

### **Self Maintenance Guide**

1. The first maintenance shall be carried out 1000 km after delivery of the new scooter or 3 months after delivery (which ever comes first).
2. After the first warranty, it is recommended to maintain once every 2000 km or 6 months (whichever comes first).

## Specific maintenance rules and items and requirements

Maintenance project	Maintenance time (month)	3	9	15	21	27	33
	Maintenance mileage (km)	1000	3000	5000	7000	9000	9000
Adjust or replace front and rear brakes		A	A/R	A	A/R	A	A/R
Check handlebar steering		C	C	C	C	C	C
Check the tire pressure		C	C	C	C	C	C
Check the disc brake system		C	C	C	C	C	C
Tighten main component		T	T	T	T	T	T
Lubrication of main parts		L	L	L	L	L	L
Front and rear suspension adjustment		A	A	A	A	A	A
Check light system		C	C	C	C	C	C
A: Adjust C: Check L: Lubricate T: Tighten R: Replace							

## 10. Warranty service

### 1. Warranty parts

Type	Warranty parts	Time
Body frame	Frame	2 years
Spare parts	Battery, motor, controller, charger	1 year
Appearance delicate parts	Handles, front and rear fenders, reflective stickers, seat pads, brake pads	3 months

### 2. Non-warranty provision

1. Unauthorized maintenance, misuse, collision, negligence, abuse, liquid entry, accident, change, incorrect use of accessories other than this product, or tear, change or anti-counterfeit labels;
2. The warranty period has expired;
3. Damage caused by force majeure;
4. It does not meet the conditions of performance failure listed in the following "Electric scooter Performance Error Sheet";
5. Failure to use, maintain and adjust in accordance with the requirements in the "Instruction Manual" will lead to performance failure of e-scooter;
6. Damage caused by human causes (including but not limited to punctured tires, collisions, marks and damage caused by normal use of appearance delicate parts, etc.);
7. Failure and damage caused by abnormal use of the product (including but not limited to overload, stepping down, falling, extreme sports, etc.);
8. If the product is used for commercial purposes, there is no warranty.

### 3. Electric scooter Performance Error Sheet

Product	Performance Error
Electric scooter	1. The motor can't work during normal use; 2. The controller is faulty during normal use; 3. The charger error during normal use; 4. The battery is error during normal use;

# 11. Legal statements

## Product legal Statement

The more familiar you are with this product, the safer you will be when riding. Please pay more attention on the followings:

- (1) Read the product instructions carefully. If you cannot ride the product according to the instructions, please do not attempt to ride the product.
  - (2) Please do not allow people who have not read this manual carefully to use the product. When you lend your product to others, you must deliver the product together with the product description, and inform them of the use method and safety tips.
  - (3) Purchase insurance in time after purchasing this product, so as to minimize the risk of use.
  - (4) You are obliged to be aware of all relevant laws, regulations and policies regarding electric bicycles/scooters/motorcycles in your area and strictly comply with the applicable laws, regulations and policies. Avoid ride in areas that are not allowed by local laws, regulations or policies.
  - (5) When you receive this product, please immediately check whether the product and accessories are intact and complete.
- Due to the special needs of the scooter in the logistics transportation, we will use the packing box to ensure its transportation safety. In order to make you better enjoy the services we provide for you, it is recommended that you keep the packing box for at least 15 days from the date of product receipt.
- (6) All products should be assembled correctly according to the instructions, improper installation may bring out of control, collision or fall, please turn off the power before installation or maintenance, in the installation of components, please strength appropriate, installation too loose or too tight may lead to product damage or present fault.
  - (7) This product may contain detachable parts, which should be protected from harm caused by children swallowing.
  - (8) Before each use of this product, please do according to your purchase model corresponding to instruction manual check tyre performance, the running state of the battery and scooter body installation status. To ensure that all parts including the brake, screw, nut has no signs of loosing or damaging so that you can avoid the poor state of the body or the part, which influences your normal driving and even leading to accidents.
  - (9) It is recommended to wear protective glasses when riding, which can prevent dirt, dust and insects in the air. Use lenses of different lightness: dark when fiber is strong, transparent when light is low.
  - (10) This product can only be loaded by one person. When riding, please keep alert and ride at an appropriate speed. No special effects are allowed

during riding.

(11) Do not park the product in the safety exit, evacuation passage and other prohibited parking areas. Do not throw or drop the product. Do not place the product on open flame or under high temperature.

(12) Use the original battery pack and charge the battery with the original charger. Otherwise, the charger or battery may be damaged or safety risks may occur.

(13) When charging, connect the power cable to the correct socket (100V-240V to 50Hz/60Hz), keep it away from children and pets, and keep it away from flammable objects. If the battery is damaged or flooded, do not use the battery after charging it. Do not charge this product when the socket is wet.

(14) It is strictly prohibited to immerse the battery or vehicle body in water or to be exposed to heavy rain or ride in the rain, so as to avoid water flooding in the battery compartment and circuit chip.

(15) Due to the work of the intelligent system and alarm system of the vehicle, the battery power will be consumed from time to time. After the battery is placed in the vehicle for a period of time, the meter shows that the power decline is normal. If the vehicle is not used for a long time (such as winter, summer or other special circumstances), please store the battery separately and maintain it regularly, otherwise it may cause the battery to run out completely and produce irreversible damage.

(16) Do not store the battery in an environment higher than 50 °C or lower than -20 °C, otherwise it will cause irreversible capacity decay of the battery.

(17) Please do not store the battery or vehicle in a place with a risk of falling, which may cause uncontrollable damage inside the battery and may lead to leakage, heat, smoke, fire or explosion of the battery.

(18) There are harmful substances in the battery. Please do not try to destroy the battery. The battery is not a repairable part. If the battery has peculiar smell, heat, deformation or other abnormal conditions, please stop using it immediately, keep away from the battery and contact the after-sales department.

(19) Warning: Due to the user's failure to use and maintain the battery normally, the battery performance deteriorates or cannot be used normally, which is not within the scope of the three guarantees.

(20) Improper disposal of used batteries may seriously pollute the environment. Please do not discard the battery pack at will to jointly protect the

natural environment. Observe local laws and regulations when disusing battery packs.

(21) Please avoid the use of non-original parts, and do not disassemble, crack or modify the product and parts without authorization. The damage and loss caused by this will be borne by you.

(22) If the product does not belong to the scope of warranty services, you need to pay for maintenance and related services.

(23) If this product and its parts need to be repaired or replaced during use, please keep the relevant after-sales service information after repair or replacement.

(24) Please strictly abide by the traffic laws and regulations in your area. Due to the differences in laws, regulations and policies of registration management and government control in different countries or regions, please confirm the local registration management and control policies and programs before purchase and use, and consult the relevant local management departments for relevant questions. The Company shall not bear any responsibility for any loss caused by the failure of registration or other policies and regulations.

### 3. Others

(1) Product data and parameters vary with different models and are subject to change without prior notice.

(2) To the extent permitted by law, our company reserves the right to interpret and explain this Statement.

(3) This Statement shall be governed by the laws of the People's Republic of China (except the laws of Hong Kong and Macao Special Administrative Regions and Taiwan Region of China). The company shall not be liable for all claims, liabilities and losses arising or likely arising out of the Consumer's breach of the terms of the above statement. Drivers should be responsible for unforeseen or unavoidable risks encountered in the course of driving.

(4) If one day you want to resell or re-gift the product you purchased, please do not forget to forward this legal declaration with you as it is part of the product. If you have any questions, I'm glad to be at your service.

Thank you again for your choice and trust in this product.



